



# Replaces Exmark Radius E-Series Parts

44in Rotary Mower - Model RAE702GEM44300,

RAE708GEM44300

Engine

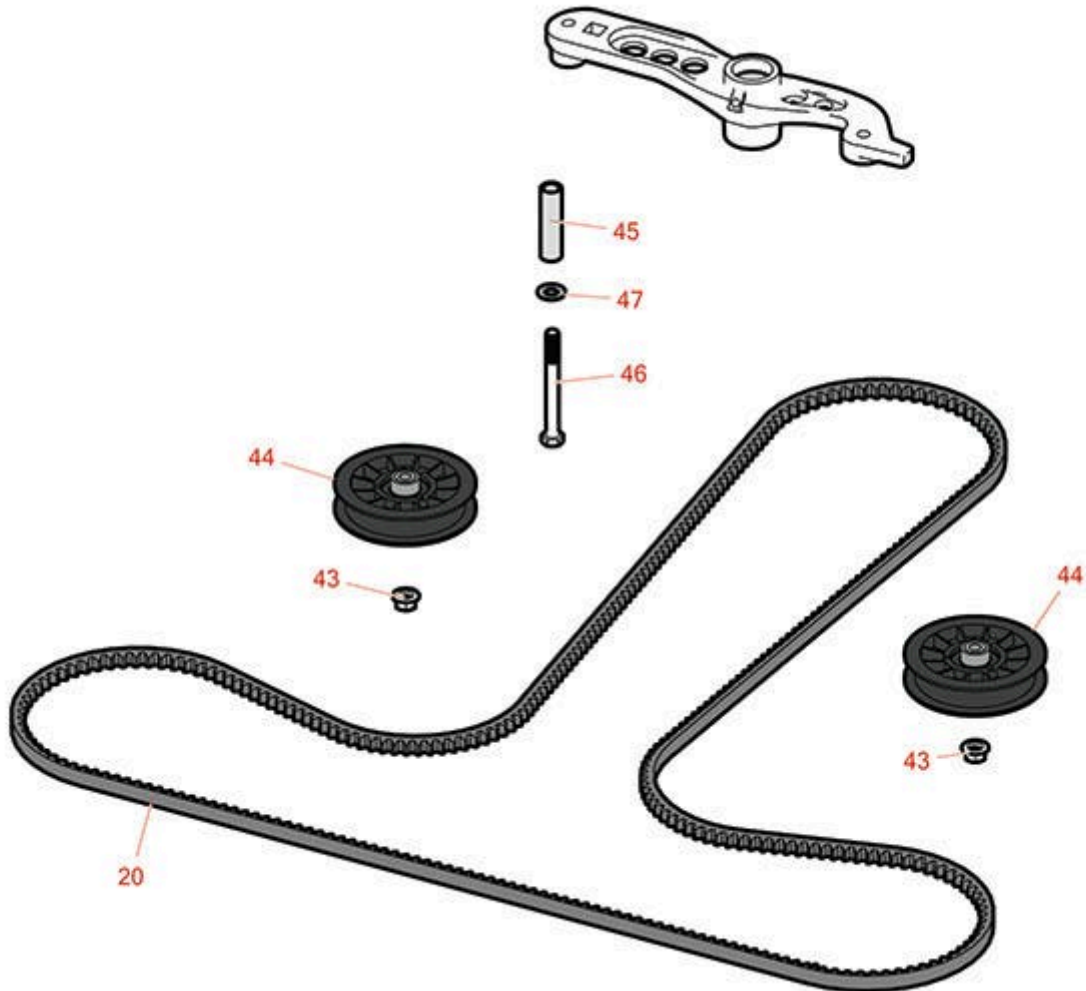
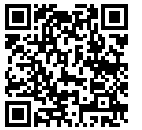

All original equipment manufacturers names and part numbers are used for identification purposes only, and we are in no way implying that our products are original equipment parts. Prices subject to change without notice.



# Replaces Exmark Radius E-Series Parts

44in Rotary Mower - Model RAE702GEM44300,

RAE708GEM44300

Engine



Item No	R&R Part No.	OEM Part No.	Description	Qty Req	Order Quantity
<b>Belts</b>					
20	<b>R115-9613</b>	115-9613	Belt - Cogged V	1	
43	<b>R104-8301</b>	104-8301, 109-6658	Locknut - 3/8-16 Nylon Flanged	23	
44	<b>R116-2456</b>	116-2456	Pulley - Flat Idler w/Bushing	2	
45	<b>R1-603384</b>	1-603384	Bushing-Pivot, Idler	1	
46	<b>R323-15</b>	323-15	Bolt - Hex HD 3/8-16 x 3-1/2 GR5	1	
47	<b>R453011</b>	3256-23, 3256-24, 3256-3, 3256-4, 48-9220, 80-7730	Washer - Flat 3/8 SAE Y/Zinc	1	

All original equipment manufacturers names and part numbers are used for identification purposes only, and we are in no way implying that our products are original equipment parts. Prices subject to change without notice.