

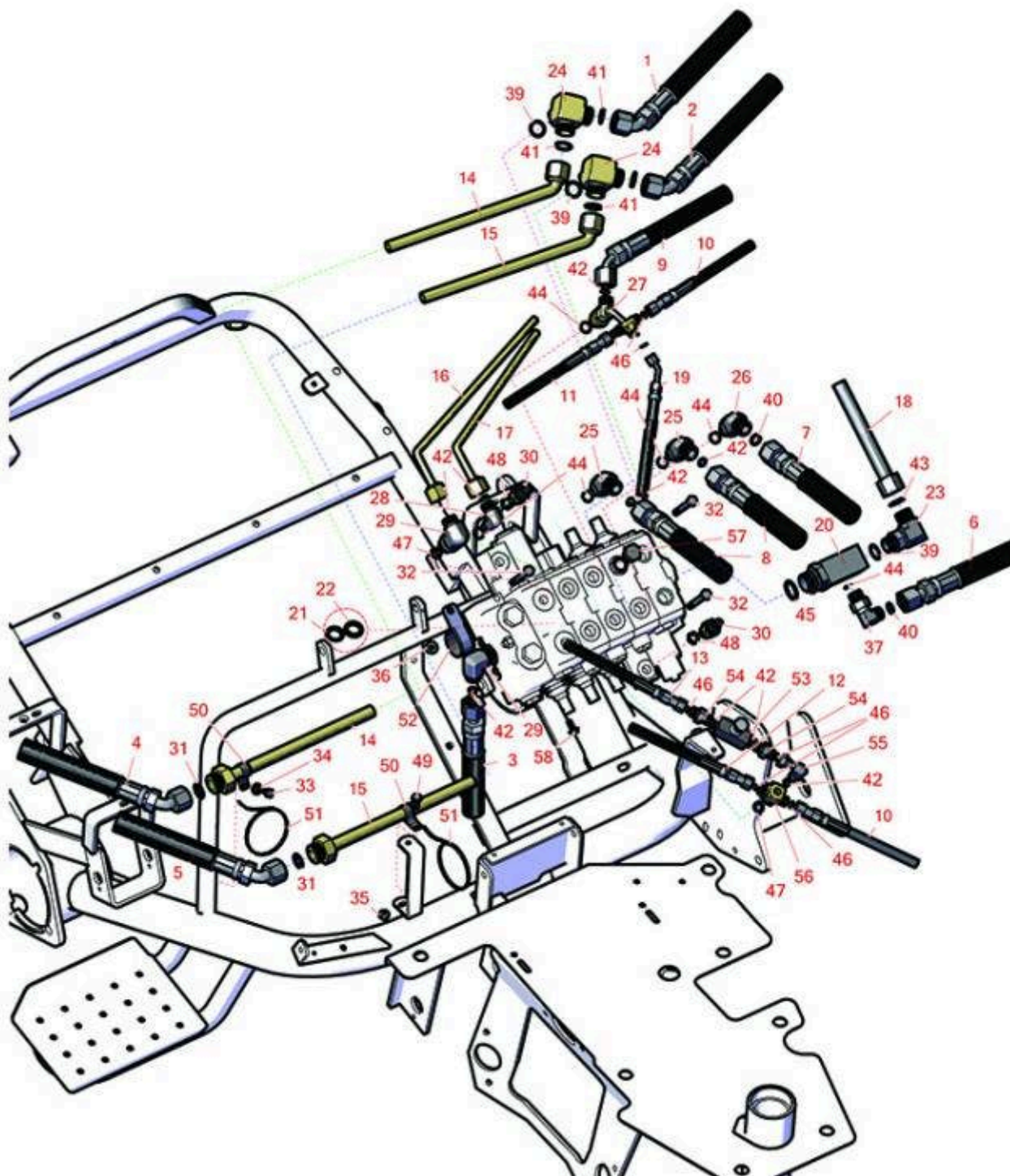

Replaces Toro Greensmaster 3050 Parts

Traction Unit - Model 04351
Control Valve



All original equipment manufacturers names and part numbers are used for identification purposes only, and we are in no way implying that our products are original equipment parts. Prices subject to change without notice.



Replaces Toro Greensmaster 3050 Parts

Traction Unit - Model 04351

Control Valve



Item No	R&R Part No.	OEM Part No.	Description	Qty Req	Order Quantity
---------	--------------	--------------	-------------	---------	----------------

Hoses

1	R150627		Hydraulic Hose Assy - Drive Motor - RH Upper	1	
2	R150641		Hydraulic Hose Assy - Drive Motor - RH Lower	1	
2	R98-0647	98-0647	Hydraulic Hose Assy - RH Drive Motor	1	
3	R150644		Hydraulic Hose Assy - Valve to Pump	1	
4	R150645		Hydraulic Hose Assy - Drive Motor - LH Upper	1	
4	R98-2153	98-2153	Hydraulic Hose Assy - LH Drive Motor	1	
5	R150642		Hydraulic Hose Assy - Drive Motor - LH Lower	1	
5	R98-0648	98-0648	Hydraulic Hose Assy - LH Drive Motor	1	
6	R150631		Hose - Rear Motor Return	1	
6	R63-3840	63-3840, 95-5987	Hose - Rear Motor Return	1	
<i>Detail Description: Hydraulic hose includes protective sleeving.:</i>					
7	R150626		Hydraulic Hose Assy - Valve to Pump	1	
7	R107-9519	107-9519, 98-2151	Hydraulic Hose Assy - Valve to Pump	1	
8	R150620		Hydraulic Hose Assy - Valve to Pump	2	
9	R95-5986	74-3830, 95-5986	Hydraulic Hose Assy - Rear Reel Motor	1	
10	R150640		Hydraulic Hose Assy - RH Lift Cylinder	1	

All original equipment manufacturers names and part numbers are used for identification purposes only, and we are in no way implying that our products are original equipment parts. Prices subject to change without notice.



Replaces Toro Greensmaster 3050 Parts

Traction Unit - Model 04351
Control Valve



Item No	R&R Part No.	OEM Part No.	Description	Qty Req	Order Quantity
11	R150632		Hose - Cyl LH Drop Fits	1	
12	R150638		Hydraulic Hose Assy - Front LH Cylinder	1	
13	R150639		Hydraulic Hose Assy - Rear Lift Cylinder	3	
14	R70-7130	70-7130	Line - Tube	1	
15	R83-1200	83-1200	Tube - LH Lower Traction	1	
16	R63-4020	63-4020	Tube - Hyd	1	
17	R63-4030	63-4030	Tube - Hyd	1	
18	R100-6431	100-6431, 63-4040	Tube - Return	1	
19	R150637		Hose - Rear Lift Cyl	1	

Other Parts Available

20	R63-4080	63-4080	Fitting - Valve Manifold - Manual	1	
21	R92-2546	92-2546	Wiper Seal - Control Valve	1	
22	R353-957	353-957	Lip Seal - Control Valve	1	
23	R340-16	100-8255, 340-16	Hydraulic Fitting	1	
24	R63-4050	63-4050	Hydraulic Fitting	2	
25	R340-138	340-138	Hydraulic Fitting	2	
26	R340-101	340-101	Hydraulic Fitting	1	
27	R83-1670	83-1670	Fitting Assy - Special	1	
28	R340-18	340-18	Hydraulic Fitting	1	

All original equipment manufacturers names and part numbers are used for identification purposes only, and we are in no way implying that our products are original equipment parts. Prices subject to change without notice.



Replaces Toro Greensmaster 3050 Parts

Traction Unit - Model 04351

Control Valve



Item No	R&R Part No.	OEM Part No.	Description	Qty Req	Order Quantity
29	R340-77	340-100, 340-77, 95-7889	Hydraulic Fitting	2	
30	R83-1890	83-1890	Ball Switch - Control Valve	2	
31	R150646		Seal - Flat	2	
32	R322-14	01-150-0830, 01-178-0524, 30-8900, 322-14	Bolt - Hex HD 5/16-18 x 3 GR5	3	
33	R12-3270	12-3270, 30-0700, 32104-17, 9266714, Aug-80	Bolt - Hex Washer 1/4-20 x 1/2	1	
34	R3256-22	24-9-BD, 3-1032, 3256-1, 3256-22, 93-0954, 93-0989	Washer - Flat 1/4 Yellow	1	
35	R301504	2296-42, 301504, 32127-24, 32128-33, 32146-17, 3296-16, 3296-42, 3296-42 , 915661P	Locknut - ESNA 1/4-20	1	
36	R445722	30-8980, 32128-2, 32128-20, 32128-20	Nut - Serrated Washer	3	
37	R150290		Hydraulic Fitting - 90 Deg	1	
39	R237-80	237-80, 327-80	O-Ring	3	

All original equipment manufacturers names and part numbers are used for identification purposes only, and we are in no way implying that our products are original equipment parts. Prices subject to change without notice.



Replaces Toro Greensmaster 3050 Parts

Traction Unit - Model 04351

Control Valve



Item No	R&R Part No.	OEM Part No.	Description	Qty Req	Order Quantity
40	R237-30	23-6320, 237-30	O-Ring - Seal	2	
41	R237-65	237-65, 237.65	O-Ring	4	
42	R237-22	107-8844, 237-22, 237-78	O-Ring	5	
43	R237-58	237-58	O-Ring	1	
44	R237-79	237-79	O-Ring	6	
45	R237-81	237-81, 237.81, 327-81	O-Ring	1	
46	R237-21	237-21, 327-21	O-Ring	8	
47	R237-42	237-42, 31-4160	O-Ring	4	
48	R38-0410	38-0410	Nut - Hex - 9/16-18 Thin-SS	2	
49	R3234-4	3234-4	Bolt - Hx Ser Was HD 1/4-20 x 3/4	1	
50	R2412-41	2412-41	Clamp	2	
51	R3M41939		Cable Ties - 8" Bulk Pkg/100	2	
<i>Detail Description: 3M Cable Ties are molded from 6/6 nylon and are available in a variety of sizes and styles, including weather-resistant black for outdoor use.:</i>					
52	R304-61	304-61	Clamp - Hose	1	
53	R150837		Flow Control	1	
54	R340-92	340-92	Hydraulic Fitting - Striaight	2	
55	R150839		Hydraulic Fitting - 90 Deg	1	
56	R150838		Fitting - Special	1	

All original equipment manufacturers names and part numbers are used for identification purposes only, and we are in no way implying that our products are original equipment parts. Prices subject to change without notice.



Replaces Toro Greensmaster 3050 Parts

*Traction Unit - Model 04351
Control Valve*



Item No	R&R Part No.	OEM Part No.	Description	Qty Req	Order Quantity
57	R353-550	353-550, 353-843	Plug - Drain - Hyd Tank	1	
58	R3274-52	3274-24, 3274-52, 52-5890	Screw - Soc HD Cap Scr	10	

All original equipment manufacturers names and part numbers are used for identification purposes only, and we are in no way implying that our products are original equipment parts. Prices subject to change without notice.