

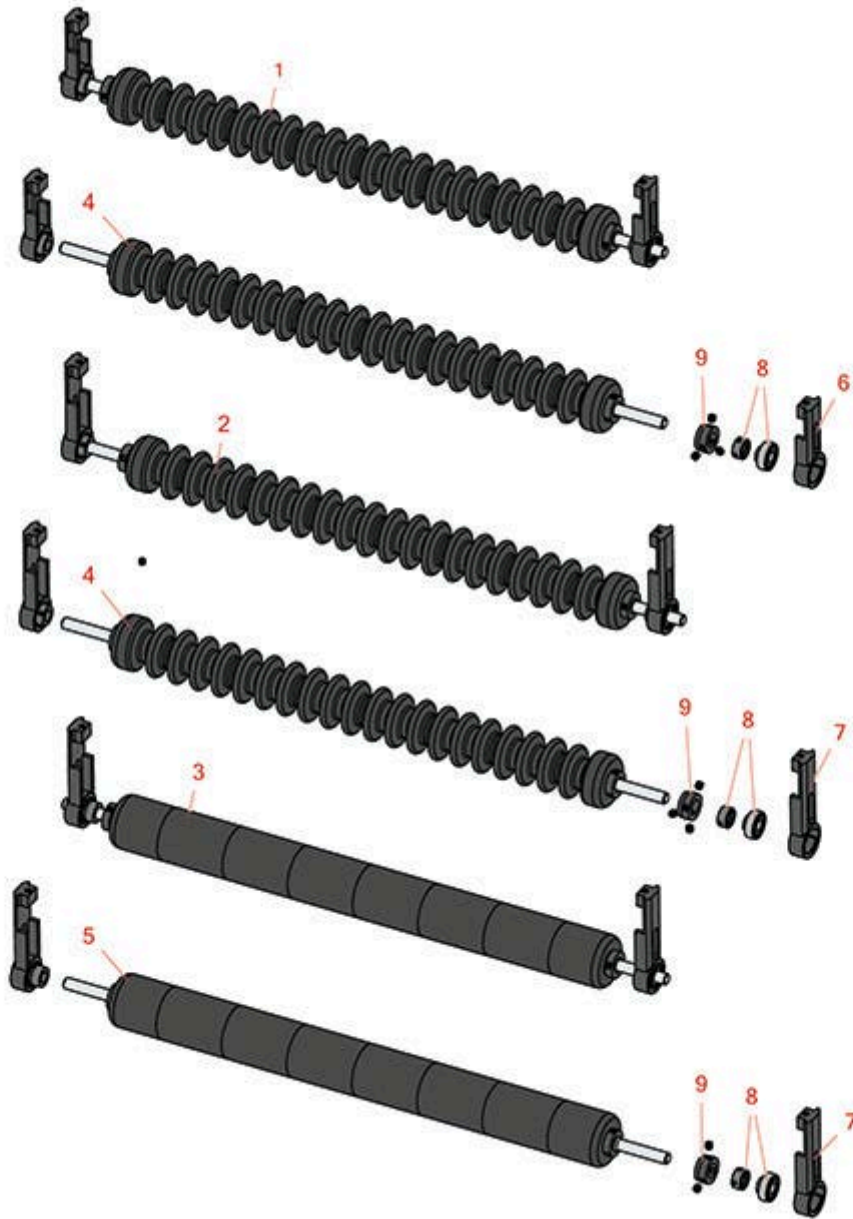

# Replaces Toro Reelmaster 2600-D Parts

32in Cutting Unit - Models 03466 & 03467  
Minuteman Roller System



All original equipment manufacturers names and part numbers are used for identification purposes only, and we are in no way implying that our products are original equipment parts. Prices subject to change without notice.



# Replaces Toro Reelmaster 2600-D Parts

32in Cutting Unit - Models 03466 & 03467

Minuteman Roller System



Item No	R&R Part No.	OEM Part No.	Description	Qty Req	Order Quantity
---------	--------------	--------------	-------------	---------	----------------

## Complete Minuteman Roller Systems to fit 32" Units

1	<b>RMT3101</b>		Minuteman Front Grooved Roller System	0	
<i>Detail Description: Complete roller systems include roller and two brackets with bearings.:</i>					
2	<b>RMT3102</b>		Minuteman Rear Grooved Roller System	0	
<i>Detail Description: Complete roller systems include roller and two brackets with bearings.:</i>					
3	<b>RMT3103</b>		Minuteman Rear Smooth Roller System	0	
<i>Detail Description: Complete roller systems include roller and two brackets with bearings.:</i>					

## Minuteman Rollers Only to fit 32" Units

4	<b>RM522</b>		Minuteman Grooved Roller Only	0	
<i>Detail Description: Fits 30" Units. Use with Minuteman Roller Bracket System Only:</i>					
5	<b>RM523</b>		Minuteman Smooth Roller Only	0	
<i>Detail Description: Fits 30" Units. Use with Minuteman Roller Bracket System Only:</i>					

## Other Parts Available

6	<b>RT221</b>		Bracket - Front RH/LH	0	
7	<b>RT231</b>		Bracket - Rear RH/LH	0	
8	<b>RMMB157</b>		Bearing w/Locking Collar	0	
9	<b>RMM3</b>		End Hub - 7/8 ID	0	

All original equipment manufacturers names and part numbers are used for identification purposes only, and we are in no way implying that our products are original equipment parts. Prices subject to change without notice.